



Adelaide

36 x 12 2 Bed Shown



2D Floorplan and Details of Changes/ Upgrades

Adelaide

36 x 12 2B



Adelaide – 36 x 12 2B



Upgrades/Changes From Standard 2021 Coworth

Carpet strip moved between living area and kitchen (window moved to be central)

1200mm x 720mm x 25mm dining table top (made in house) with Braced Ankara table pedestal in Colour 1

4 x Stockholm dining chairs with colour 1 legs

Ryedale front bay added (internal changed to accommodate pelmets)

2 x separate fixed sofas added (Roelcliffe style)

Feature wood colour changed to Pfeleiderer U18004 NW

25mm tops added to kitchen units

Coworth Deluxe TV/Fire unit

4 x lounge scatters

Extractor and full height coloured splashback in kitchen (details of splashback TBC)

Integrated fridge freezer and microwave

Occasional table and 2020 Ambleside style footstool in lounge

Wet winter pack

Pre-galvanised chassis

Furniture doors throughout

New picture in dining area (Details TBC)

Range to include option of top lockers to all bedrooms

New fabrics throughout

Sheet Materials as 2021 Coworth (apart from feature wood)

3D Floorplan

Adelaide

36 x 12 2B

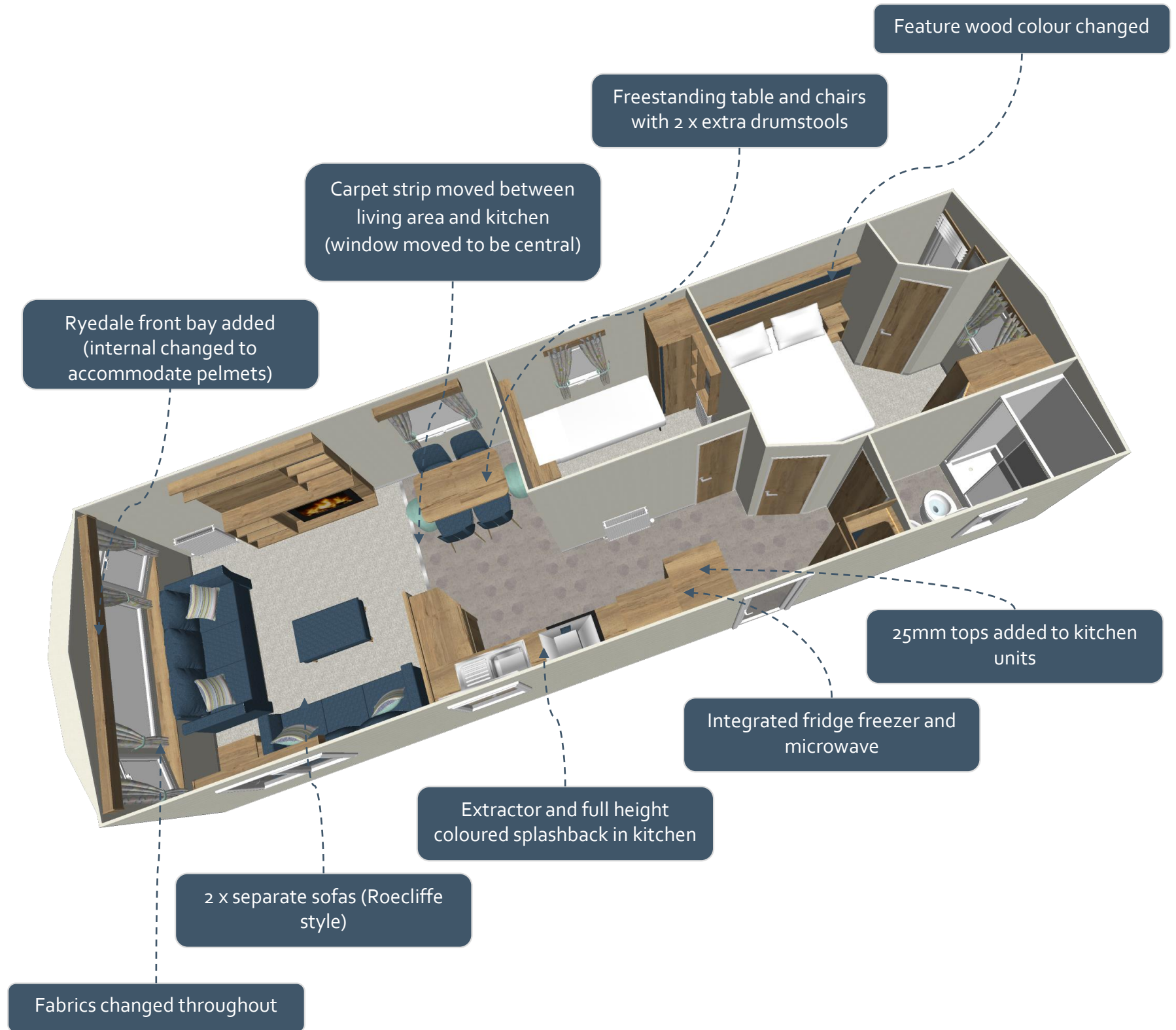

Adelaide

36 x 12 2B

3D Visuals

Open Plan Living Area



Adelaide

36 x 12 2B

3D Visuals

Open Plan Living Area



Adelaide

36 x 12 2B

3D Visuals

Kitchen/Dining Area



Adelaide

36 x 12 2B

3D Visuals

Main Bedroom

